



Series
MPX

SIZE 20 REAR RELEASE. REAR REMOVABLE
TIN LEAD DEPOSIT ON PC POST PIN CONTACT

Issue:
20/04/99

Page
1 / 1

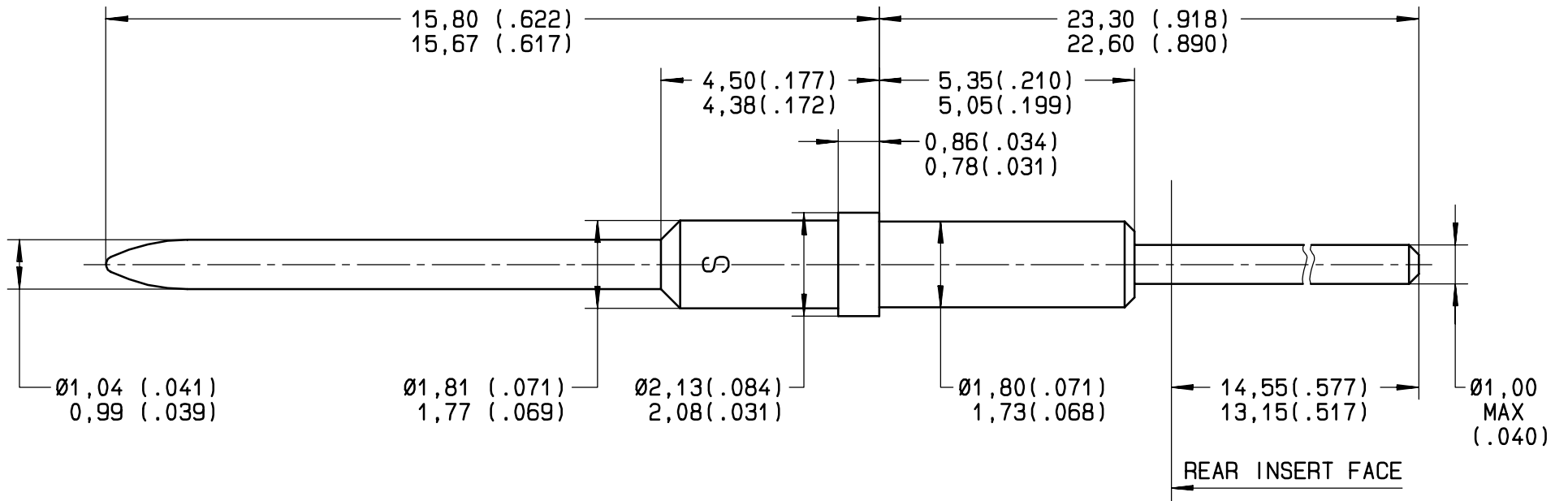

MATERIAL:

LEADED NICKEL COPPER C97

FINISH:

.00005 INCH OF GOLD PER MIL-G-45204 TYPE I OR II, GRADE C OR D, CLASS1 OVER NICKEL PER QQ-N-290
PWD SOLDER CONTACT AREA WHICH IS TIN LEADED PER QQ-S-571

INSERTION/EXTRACTION TOOL: M81969/1-02 (RADIALL 282886)

This information is given as an indication. In the continual goal to improve our products, we reserve the right to make any modifications judged necessary.

4112-9610

CREATION	Issue	Revisions	Name	Approved
PEN: M990009332A				
NOM: MACARI				
DATE: 20/04/99				
APPR.: .				

RADIALL[®]

101, rue Philibert Hoffmann Z.I. Ouest
93116 ROSNY/BOIS Cedex (France)
Tl.: 01 49 35 35 35
Fax.: 01 48 54 63 63
Tlax: RADIA 235220